



SAUMYA
BUILDCON
— CRAFTING LIFESTYLES —

Member of
CREDAI
NASHIK METRO

JUNNARE HEIGHTS

PREMIUM 2 BHK & 3 BHK RESIDENCES

(MAHA RERA No. P51600031205)



WE AT SAUMYA BUILDCON

We as an Associates of **SAUMYA BUILDCON** offers you 25+ years of expertise in transforming the Residential Skyline of Nashik. Delivering customers their dream homes which can foster memories for generation and a place for dreams and aspirations of your family . It is an emotional decision built on trust.

Nashik has trusted us with their homes and we are committed towards Uncompromised Quality, Unparalleled Service and Extreme Transparency at every stage of the process. We have completed 50+ Projects and MORE THAN 5 LACS square feet of **RESIDENTIAL & COMMERCIAL** developments across Nashik.

We are guided by our vision - '**CRAFTING LIFESTYLES**' to create landmark developments across residential markets, gaining trust and confidence. Ever since the inception of organization, we have always strived to establish ourselves as a Trustworthy, Value-Driven and Committed Brand as our company's core values.

ABOUT THE PROJECT

Blessed with in the vicinity of lord Ichapurti Ganesha & ISKCON's Lord Shri Krishna, JUNNARE HEIGHTS is one of the largest and the most ambitious residential projects in hert of the Nashik city, built on the trust of SAUMYA BUILDCON. It is a well Planned nest among the hustle and bustle of Nashik, offering a concierge of amenities at your doorstep to unwind for the day. The Residents are greeted with a Designer's GRAND ENTRANCE LOBBY & LANDSCAPED COURTS which leads to your lovely adobes.

LET'S TAKE THE CLOSER LOOK

The Size, Ambience, Location, Amenities and the Affordability, raise no question of Compromise. Your aspiration for a Global Lifestyle ends here. We welcome you to our Most Prestigious Project having Elevators with battery backup, Wide Driveways, Allotted Parking which will end your everyday worries once and for all.

YOUR HEALTH AND WELLNESS REMAINS A PRIORITY

HEALTH IS WEALTH, A Healthy and Fresh neighborhood is a key to life's prosperity. This Project is a perfect amalgamation with State of the Art, Jogging track along with Lush Greenery & Music system, An Acupressure Pathway, Meditation & yoga Pavilion to hit the right gears for your perfect start of the day.

Our Vision CRAFTING LIFESTYLE by providing Amenities on the Terrace Garden "**NATURESCAPE - Escape to the Elevated lifestyle**". The member of your family who are in their childhood and also in their second childhood, are taken care of, A chit chat corner, State of the Art facilities for the young brigade to enjoy the budding years of their life with dedicated Children's Play Area and platter of Indoor games which will bring out the best in their tender age to mould the bright future of our Country.

DIVE DEEP INTO LUXURY

The Project Engulfs you in a Blanket of Luxury, with unparallel experience of premium amenities like Gazebo, Sundeck, Observation Deck, Relaxation Court, Camp Fire Area, Multipurpose Platform with Sizable Party Lawns with Buffet and BBQ setup, so that you'll love to Host & Invite your Friends & Relatives over and over again

EVERYDAY IS EARTH DAY

Keeping in mind the Environment, we believe that everyday is Earth day, Green energy solution - Solar panels ensure no harm to the Environment, Solar lighting for common areas reduce our energy consumption by over 30% and result in lower society maintenance cost. E - vehicle Charging Points for each Unit, Rain Water Harvesting truly take this PROJECT into the arms of nature.

UN-COMPROMISED SECURITY

A Comprehensive 3 tier security with gated community ensures nobody can caste an evil eye on your home. With 24*7 CCTV Surveillance, Security Cabin and Entrance Gates will ensure you a peaceful sleep at night while our security on the vigil.



NATURESCAPE

ESCAPE TO THE ELEVATED LIFESTYLE

At NATURESCAPE, a Rooftop Terrace Landscape Featuring Lifestyle amenities that will boost your Senses in every possible way. Come Lets have a Look & ESCAPE TO THE ELEVATED LIFESTLYE



"Music is the language that the soul hears", We at "NATURESCAPE" have taken this quote and Designed it to a One kind of a Musical experience along with the Jogging Track.

A state of the Art Jogging Track on the Rooftop to Indulge in Fitness with Glorious Views of the SUNRISE & SUNSET and Notch above the Bustling CITYLIFE of Nashik.



"A healthy Community is a Vibrant community", A unique concept of Reflexology / Acupressure Court right Besides the Jogging Track.

Kid's play area Intelligently Designed to help the kids become socially Aware to gain Confidence & Interact with others and keep Physically fit in the blooming years of their Life.



Let the Senior Members of our Family Relieve their Childhood & Groove into Stories, Music & Gossips in the dedicated Senior Citizens court.

We have Redefined our spaces for a Vibrant Communal Experience featuring a Sit Out which will surely give you Nostalgia of your Childhood.

A one kind of Gazebo with Ambient Lighting to offer a Perfect area for Family Get together's & enjoying the Beautiful Evenings with the Favorable Climate of Nashik



The Broad & Well Designed Sundek is surely a Therapy in itself, your chance to absorb all the godliness Nature has to offer.

HEALTH is always a Priority, Dedicated Space for YOGA & MEDITATION gives you a Perfect start of your Day with Freshness & boosted Immunity.

Beautifully Designed Greens & Meticulously Designed Landscapes Invites Pets to play around & for Bird's to find their Homes.

Intelligent use of light for setting up an Ambient Evening spread across the Terrace Landscape for a Mesmerizing experience.

A feature for the Trendy youth along with A party Lawn for hosting a Lovely Evening Party to Enjoy with Family & Friends.

Semi Covered Seating areas with Pergolas to Deliver a Unique Blend of Experience for A Modern Yet Traditional Architectural Design.

A multipurpose Area with a Feature wall enables you to Host a number of events & arrange small Get together, that will bring your Social connect at a Ease.



Well Planned, Landscape Terrace with a perfect mix of Greenery, Trails, Play Area, Lawns, Sit outs, Camp Fire Area, Decks, Ambient Lighting which Deliver a wholesome Experience to unwind for the Day.

LOWER GROUND FLOOR PLAN

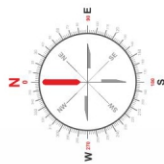

GROUND FLOOR PLAN

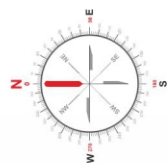

FIRST FLOOR PLAN

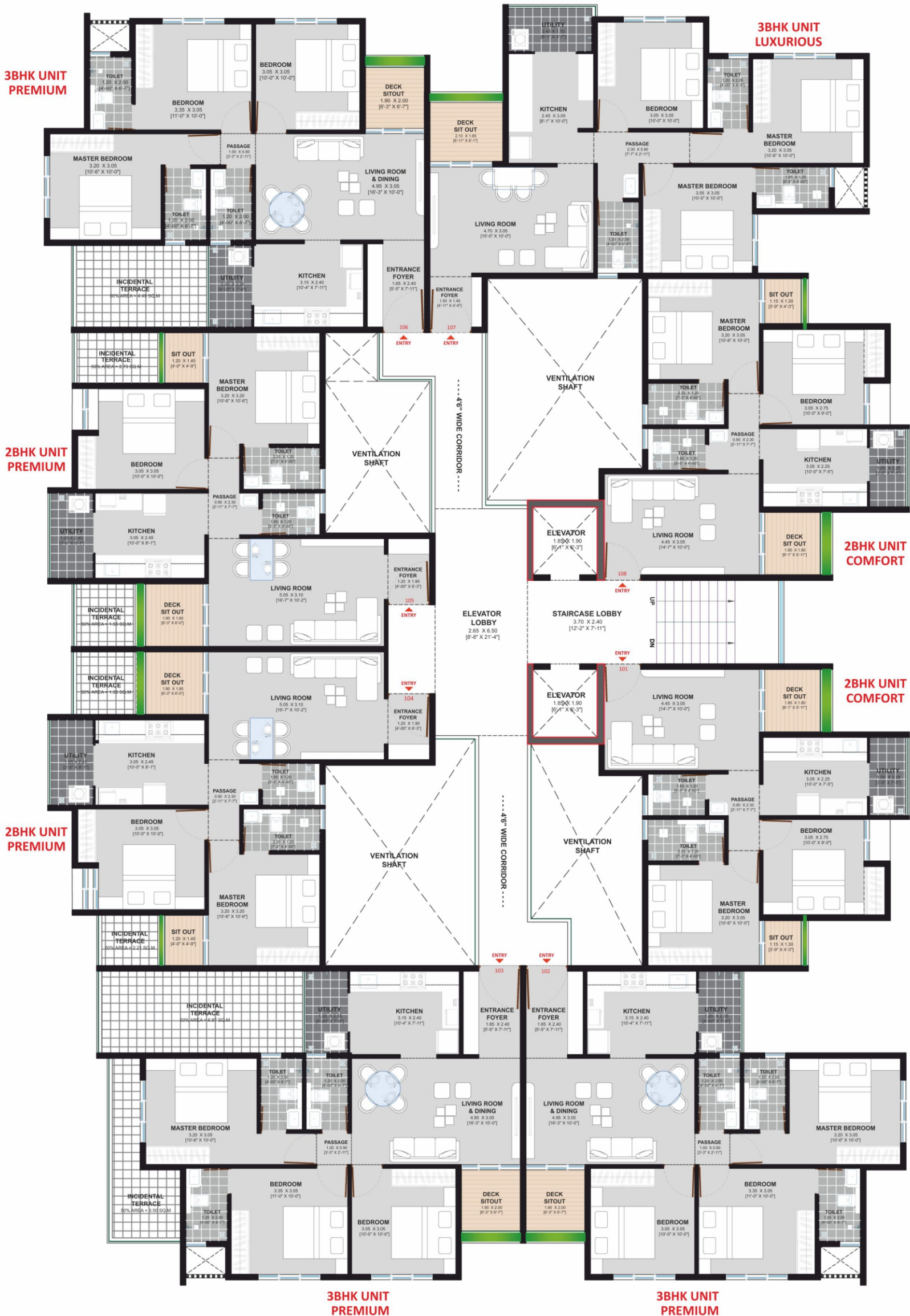



SECOND TO FIFTH FLOOR PLAN

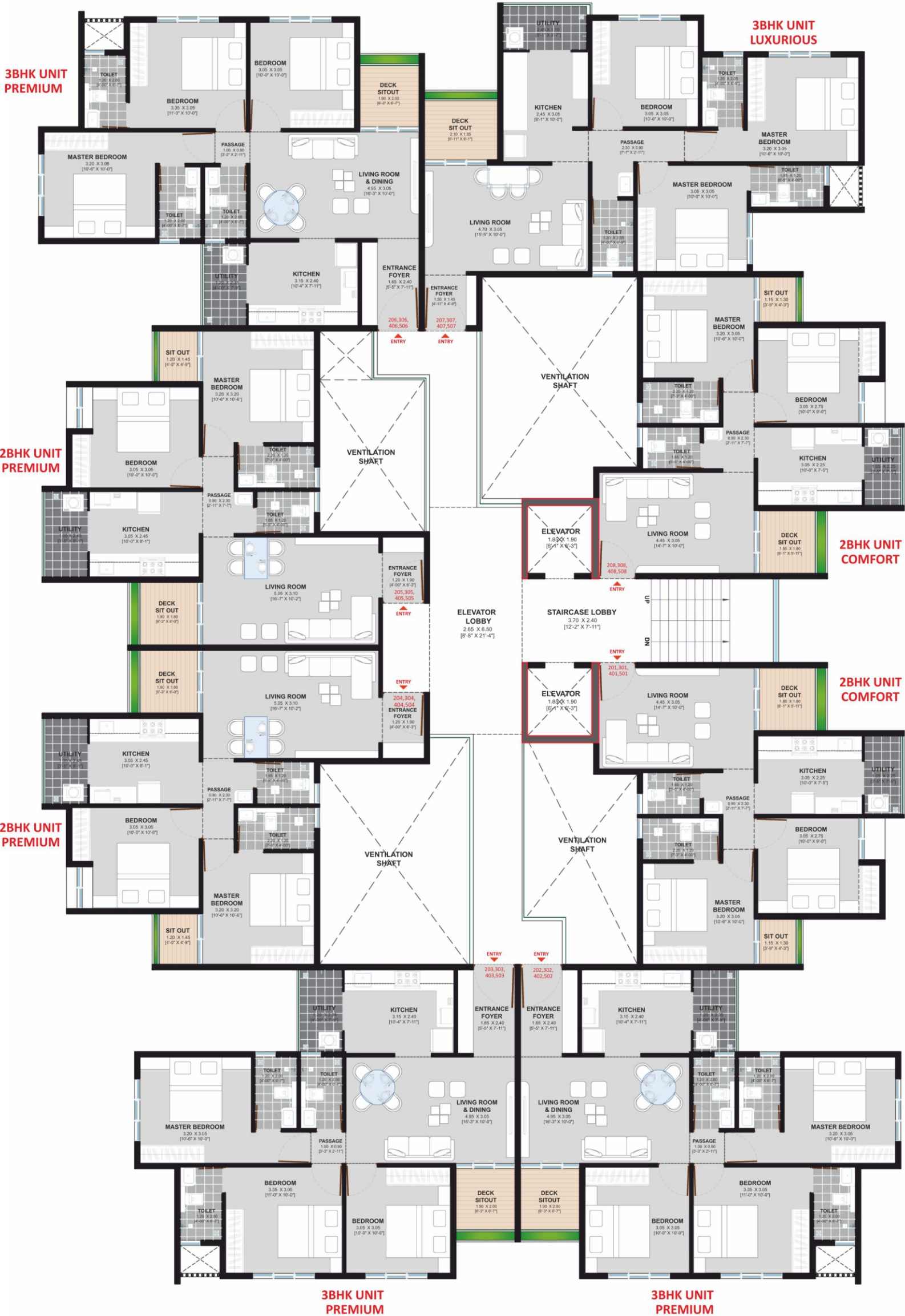
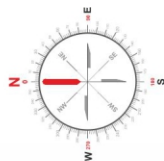

SIXTH FLOOR PLAN

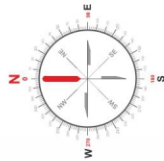

PENTHOUSE
LOWER
LEVEL

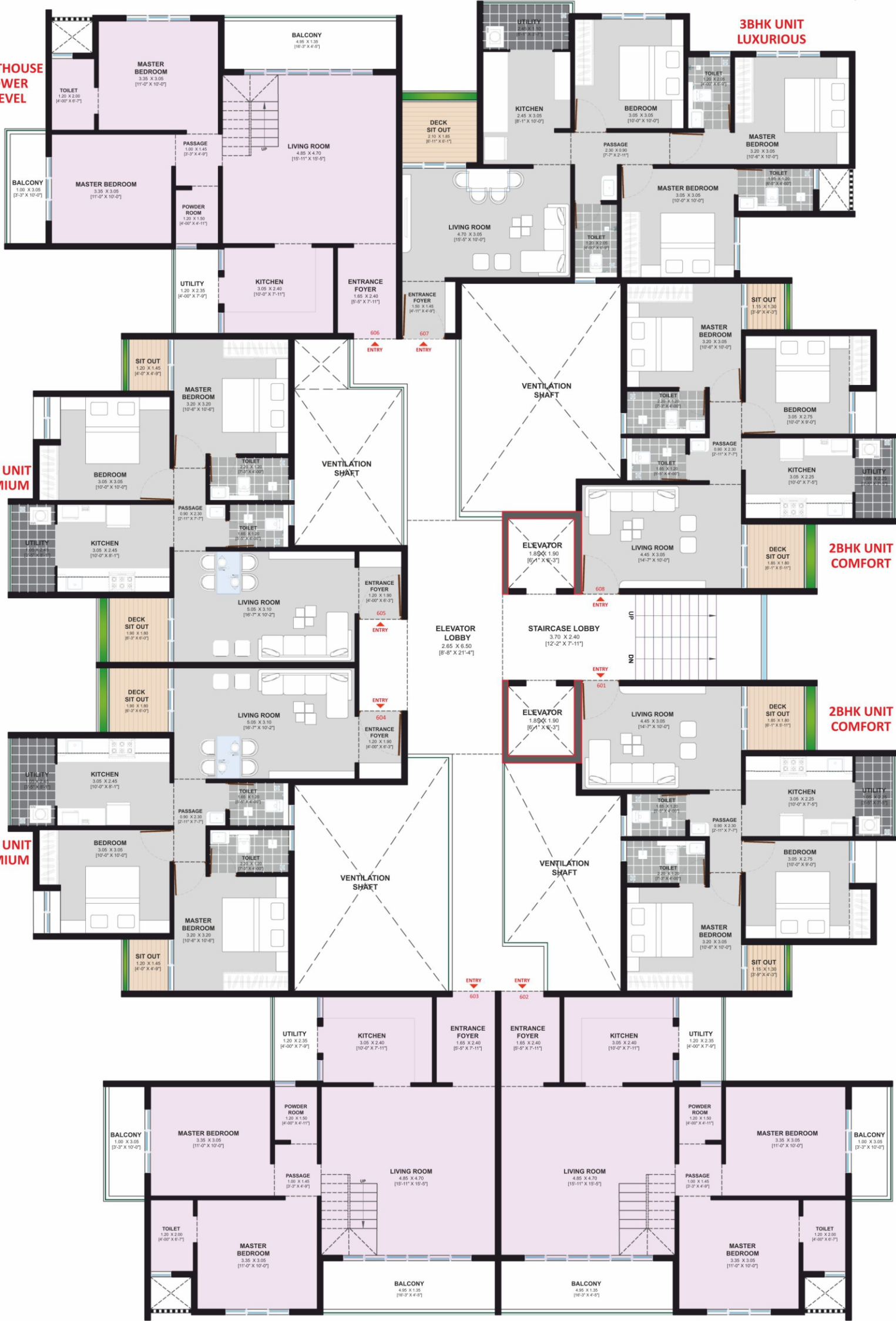

TERRACE AMENITIES FLOOR PLAN (NATURESCAPE)



NATURESCAPE LEGEND

01. MULTIPURPOSE PARTY AREA

02. MULTIPURPOSE PLATFORM

03. JOGGING TRACK WITH MUSIC SYSTEM

04. SUNDECK

05. REFLEXOLOGY / ACUPRESSURE PATHWAY

06. GAZEBO WITH SEATING

07. YOGA / MEDITATION COURT

08. CAMP FIRE AREA

09. KID's PLAY AREA

10. ROCK CLIMBING WALL

11. SENIOR CITIZEN's COURT

12. SEMI COVERED CHIT CHAT CORNER
13. RELAXATION DECK

14. AROMA GARDEN WITH ZEN STONE

15. BBQ SET UP AREA

16. OBSERVATION DECK

17. DEDICATED TOILET

18. ROOF TOP SOLAR PANELS

19. AMBIENT LIGHTING

20. ARTIFICIAL LAWNS FOR PARTY AREA

21. FEATURE WALL FOR PARTY AREA

22. DEDICATED LIFTS UPTO TERRACE

23. EPDM FLOOR FOR KID's PLAY AREA

24. CANE CHAIRS FOR RELAXATION AREA



2 BHK UNIT - CUT VIEW



NATURESCAPE : THE TERRACE LANDSCAPE



3 BHK UNIT TYPE 'A' - CUT VIEW



3 BHK UNIT TYPE 'B' - CUT VIEW

COLLABORATIONS WITH THE BEST

BRANDS THAT CREATE YOUR HOME

FLOORING



FINEST QUALITY OF CERAMIC

Tiles for every application in a Plethora of Colors, Textures & Designs of International class.

CP FITTINGS



NO. 1 BRAND IN ASIA

Bathroom Fittings of Highest Quality Standards & Aesthetics for the Premium & Luxury Bathroom Segments for an Unmatched Experience.

SANITARY WARE



FINEST QUALITY OF CERAMIC

Intelligent Products for Beautiful, Functional, Comfortable & Sustainable Bathrooms that ensure Well Being for many Years to Come.



FRENCH DOORS

INFINITY DOORS

Door that Secures Homes as well as Make them Visually Appealing & Exclusive.



KITCHEN SINKS

STYLING THE KITCHEN

Leaders in Steel Sinks with Striking Innovative Looks & styling at its Ability & durability.



SOLAR PANELS

ONE WITH THE SUN

WAAREE is both a Global Leading Manufacturer of Solar Panels & Solar Energy Solutions.



PAINT

INDIA'S LEADING BRAND

Since 75 years & Leaders in Interior Wall Finishes, Exterior wall finishes, Enamels & wood Finishes.



LOCKS

ANTI-THEFT ENGINEERING

In the Locking Solutions, Locks for Every Need that Guarantee Peace of Mind.



PLUMBING

PIONEERS & LEADERS

Providing Solutions for every Plumbing & Piping needs with no Compromise on Quality & Durability.



CABLES

CONNECTION ZINDAGI KA

Polycab is one of India's Leading manufacturers of Cables & Wires.

DISCLAIMER: The Plans, Specifications, Images & Other Details herein are only indicative/ Conceptual which we Reserve the right to change any or all of these at our sole Discretion and are subject grant of Approvals from relevant Authorities. This printed material does not constitute an offer, an Invitation to offer &/ Commitment of any nature between us & the Recipient. All images Shown are Artists impressions. Design, Cost, Facilities, Plans & Specifications in Static or Interactive Publicity Material Depict Anticipated Appearance of completed Development. This Information is Presented as General information & no warranty is expressly or impliedly given that the Completed Development will comply in any Degree with such Artist's Impressions or Anticipated Appearance. The Furniture shown in the Plans are only for the Purpose of illustrating/ indicating a Possible Layout.

SITE LOCATION

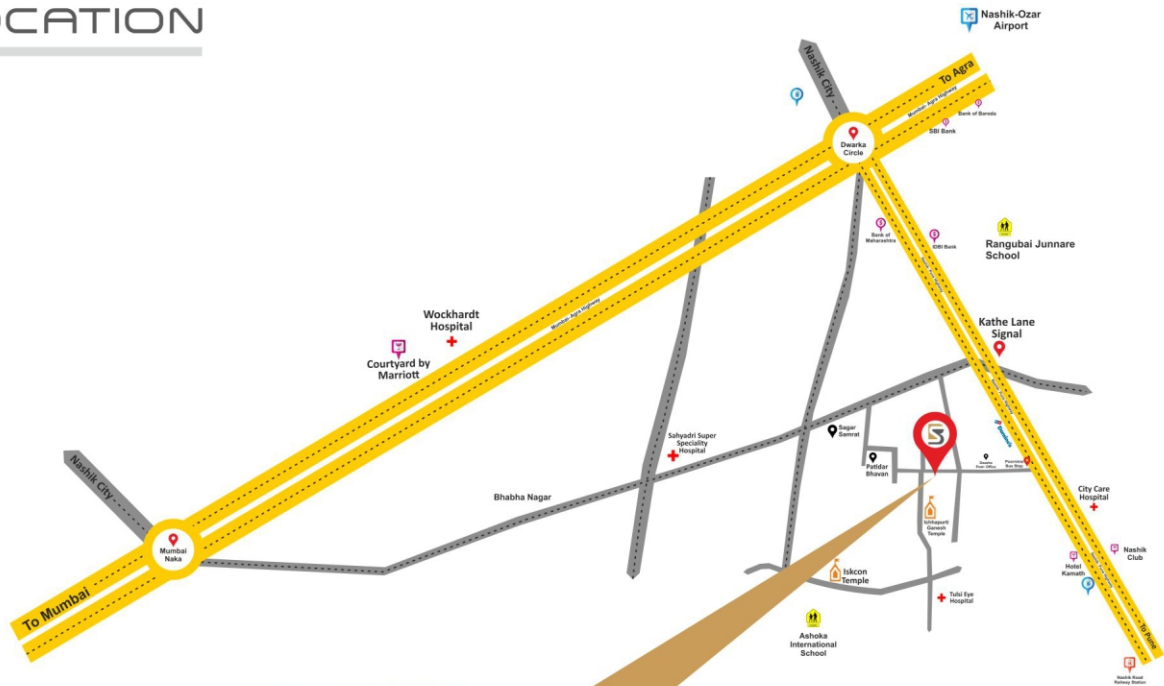

SITE ADDRESS

P. No .01, Gen. Vaidya Nagar,
Near Pournima Bus Stop,
Nashik - Pune Road, Nashik - 11

KEY DISTANCES

RAILWAY STATION = 5.50 KMS	ASHOKA INTERNATIONAL SCHOOL = 1.00 KMS
MAHAMARG BUS STAND = 2.00 KMS	PODDAR INTERNATIONAL SCHOOL = 1.50 KMS
DWARKA CIRCLE = 0.50 KMS	NASHIK CLUB = 0.50 KMS
OZAR AIRPORT = 17.00 KMS	ICCHAPURTI GANESHA TEMPLE = 0.10 KMS
SAHYADRI HOSPITAL = 0.50 KMS	ISKCON TEMPLE = 0.20 KMS MTRS

A Project By:



REGISTERED OFFICE

4, RATNAPRABHA Residency, Opp. Hotel SSK Solitaire, Tidke colony, Nashik - 02.
saumyabuildcon2021@gmail.com www.saumyabuildcon.com

ARCHITECT



RCC DESIGNER

Er. RAMESH WAGH

Approved By



https://maharera.mahaonline.gov.in

For Booking Contact
94222 45711 / 97300 87100

SCAN FOR MORE